

# 未来の風景と役割

Landscapes of the Future and Role

蘇 浩龍 *Bosco SO*

東京大学 (景観研究室), 香港造園家学会, 国際造園家連盟  
The University of Tokyo (Keikan Lab), HKILA, IFLA



## 1. IFLA APR Achievement and way forward

First and foremost, I would like to thank JILA for giving me a chance to share my thoughts here. My position is the chairperson of communications and external relations in IFLA APR. Learned from the sharing from the landscape architects all over the world during IFLA world council and congress meeting, I believe landscape designs can be altered by culture, practice, principle, governance, craftsmanship, history, and technology. *Landscape Architect - Kathryn Gustafson: A Place that Fits - helps foster the awareness of the profession of landscape architecture and its relevance to contemporary society.* Indeed, every country has its own Landscape Architecture institute and the power of the landscape architecture community can be empowered in a promising way. Some common issues have been found between these institutes, For instance, Urban resilient city (HK & Tokyo), River flood issue (Tokyo, HK & Bangkok), Urban agriculture (HK vs Tokyo vs Taipei, Seoul & SG) and Basophilic (HK vs Singapore vs Tokyo). All of these issues are the common grounds for landscape architects to devise appropriate design solutions.

*"I like thinking big. I always have. To me it's very simple: if you're going to be thinking anyway, you might as well think big." - Rem Koolhaas*

Now it is time for us to make an alliance with different nations achieving the same goal for our beloved cities. In the near future, it aims to create more exchange platforms for young landscape architects and practitioners to express their views and creativity, by holding an international seminar and workshops.

## 2. Practice experience before came to Tokyo, Japan

Before I went to Tokyo, I practiced at HOK Architect Ltd, TFP Farrells Architect and AECOM during and after the graduation of my master's degree in Landscape

Architecture at The University of Hong Kong. Because of the unique geological location of Hong Kong, there are many foreign companies that choose to set up their headquarter in Hong Kong for handling Asia-Pacific businesses. Undoubtedly, I have learned different ways of design execution and some innovative ideas from my previous companies.

A wide variety of design configurations have been found in the past practices; I reckon that there are several ways to tackle problems in landscape design. Aside from the functional issues, there are also other issues in culture, history, community, climate, topography, ecology and adjacent environment.

Even when two similar project natures are put in comparison, I realized that the design outcomes were quite diverse in my former practice company. (Fig 1) Nowadays, the idea of opening up the nursery park as a demonstration and education for citizens is a new approach. Below is on the project I participated during the designing stage:

## 3. Reason for studying in Tokyo, Japan and Practice experience

When I was studying for my landscape architecture degree at the University of Hong Kong, I knew more about the history of architecture in the Asia world. It is no secret that I appreciated Japanese culture including design, custom, craftsmanship, history and the community. Certainly, I have inspired by several architects' works, one of them is from Hiroshi Naito. Owing to the British colonial background of HK, there are many integrations between Chinese and Western architecture. Bringing a new insight to my origin and creating a better design theory for my city has become one of the reasons that led me here in Japan. During my last two years in TokyoU, I have received multi-perspective insights of landscape architecture and civil engineering. Special thanks to

Professor NAKAI Yu, Professor Makoto Yokohari and Mr. Masa Kitauchi for their guidance.

*“For me, I always think there are Body and Soul in architecture. Body is a container for hardware and Soul is a space created in it.”, a quote by Hiroshi Naito.*

In the beginning of 2018, I got a chance to work as a part-time landscape designer in Nikken Sekkei. I have broadened my horizons and learned a lot from my tremendous team and leaders, Kaneko san (from Landscape Architect) and Sato San (Urban Planning and Design). Both regional and international projects at Nikkei Sekkei made me feel excited to assist my team every time.

#### 4. Vision for Landscape Architecture

My vision for landscape architecture is through landscape architecture application, it can benefit several aspects particularly: Autism Spectrum Disorder (ASD), the landscape for infrastructure/ noxious facilities.

To me, nature does play an important role. It helps kids to overcome, or experiment with their textual sensitivities when they are exposed to it. (Fig 2) Nature also provides exploration opportunities, as well as enhanced opportunities for them to touch ground surroundings. Most of the playgrounds and parks in HK may too rely on the safety and maintenance. There are not enough Inclusive Playgrounds for kids. Most of the children (ASD) become unpleasant when encountering a severe sensory stimulant. On the other hand, a rapid development of noxious facilities is inevitable. *NIABY - Not in anyone's backyard* has been stamped in everyone's heart. Every city must face the problem when creating more facilities. Apparently, there is no comprehensive design execution to soften the antipathy of NIABY.

*“People can inhabit anything. And they can be miserable in anything and ecstatic in anything. More and more I think that architecture has nothing to do with it. Of course, that's both liberating and alarming” - Rem Koolhaas*

If we don't start thinking beyond the restrictions and stop being limited by the current rules and configuration. The ideal of coherence may become more difficult to achieve. Undoubtedly, the acceptance of certain realities doesn't preclude idealism. It can lead to certain breakthroughs. It is time for the Landscape Architects Union to gather and synergize with each other. (Fig 3)

#### Reference:

Interview of Architect, Rem koolhaastect/ <https://www.arch2o.com/why-reasons-rem-koolhaas-architect/>

#### Projects:



Fig 1. WKCD Nursery Park, Hong Kong, Designed by: Bosco So (ACLA Ltd) & WKCDA



Fig 2. Tuen Mun Inclusive Playground Design competition, Professional group winner: Bosco So

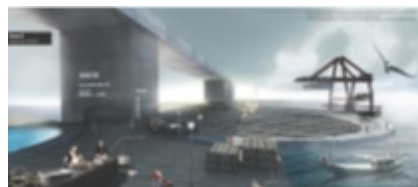

Fig 3. Bio-mimicry approach for filtering the polluted water caused by the construction of Infrastructure for HZMB-HK, Designed by Bosco So

Bosco is a Registered Landscape Architect in HK. Also, he is a PhD candidate in Design and Landscape at TokyoU. He received his MLA with distinction at HKU. He was selected to be a professional member of HKILA in May 2018. His effort and skills in design have been repeatedly recognized in his International studio working experience and various regional and national competitions. In 2015, Bosco was awarded the winner of UNICEF inclusive playspace design competition in the professional group. The winning entry was built in Tuen Mun Park, HK in 2018.